



Mercedes-Benz V Klasse

Art. 818735 (L1 & L2)

Astmelauad TOUR | Runnings Boards TOUR | Боковой пороги TOUR



1. Astmelauad/runnings boards/боковой пороги	1+1
2. Kronstein / bracket / кронштейн	2
3. Latt / bracket / кронштейн	4
4. Latt / bracket / кронштейн	2
5. Latt / bracket / кронштейн	2
6. Vinkel / angeled plate / угольник	2
7. Vinkel / angeled plate / угольник	2
8. Kronstein / bracket / кронштейн	2
9. Kronstein / bracket / кронштейн	2
10. T-polt / T-bolt / T-болт	10
11. U-polt / U-bolt / U-болт	2
12. Polt / bolt / болт M6x20	4
13. Polt / bolt / болт M10x30 Wülock	28
14. Polt / bolt / болт M10x35	2
15. Mutter / nut / гайка M6	8
16. Mutter / nut / гайка M10 DIN 934	10
17. Mutter / nut / гайка M10 DIN 985	30
18. Seib / washer / шайба 6,4x12x1,6	12
19. Seib / washer / шайба 10,5x30x2,5	42
20. Vedruseib / spring washer / пружинная шайба A10	10
21. Vinkel / angeled plate / угольник	1

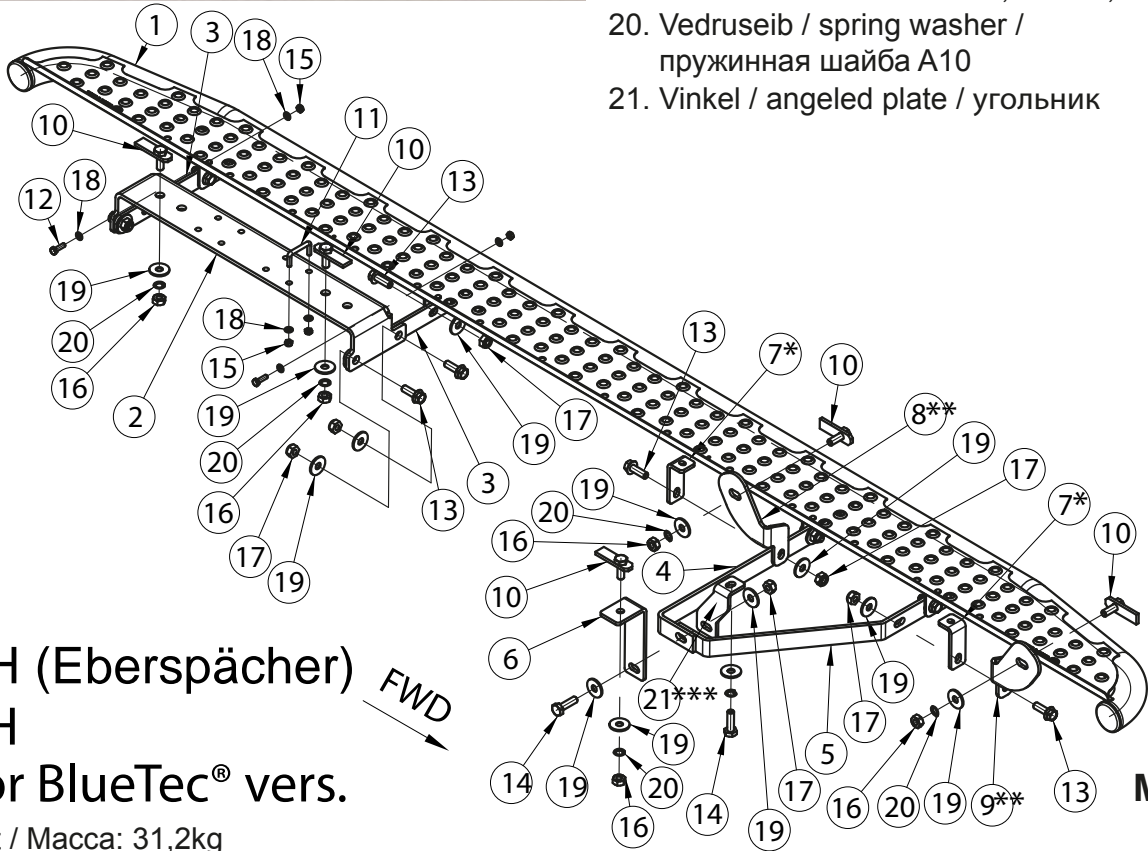

* - LH (Eberspächer)

** - RH

*** - For BlueTec® vers.

FWD

M6 - 11Nm
M10 - 50Nm



Kaal /Weight / Масса: 31,2kg

Paigaldusaeg / Time of mounting / Время установки: 90 min

Vajalikud tööriistad / Required Tools / Необходимые инструменты



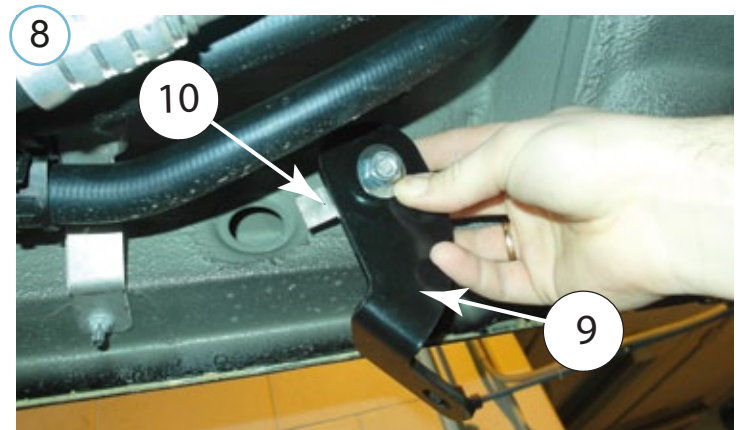
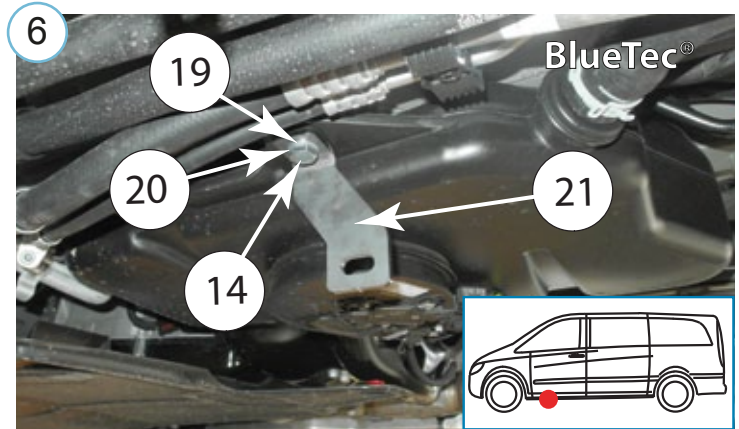
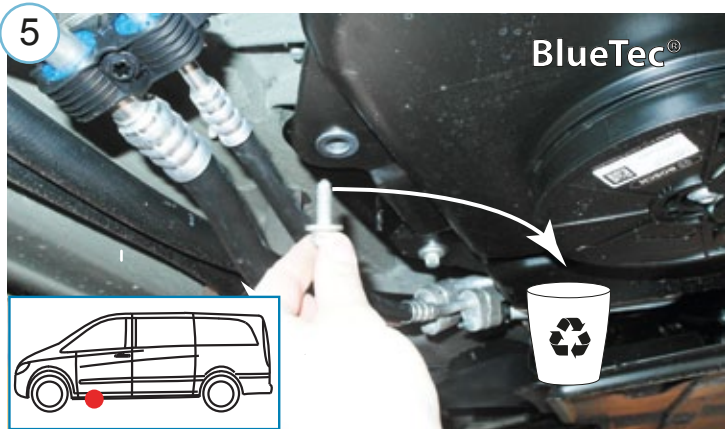
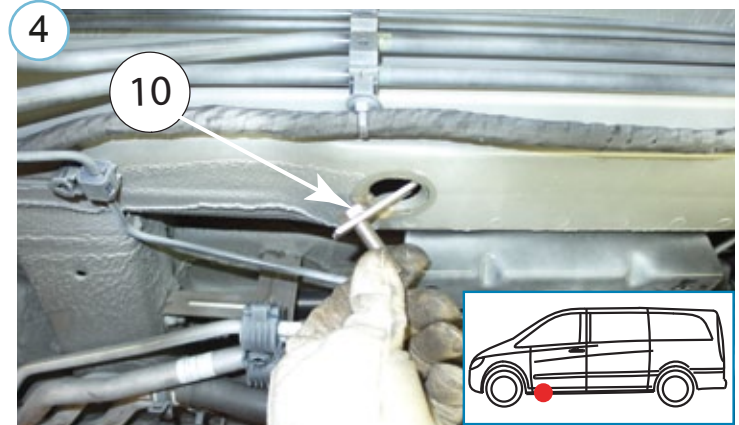
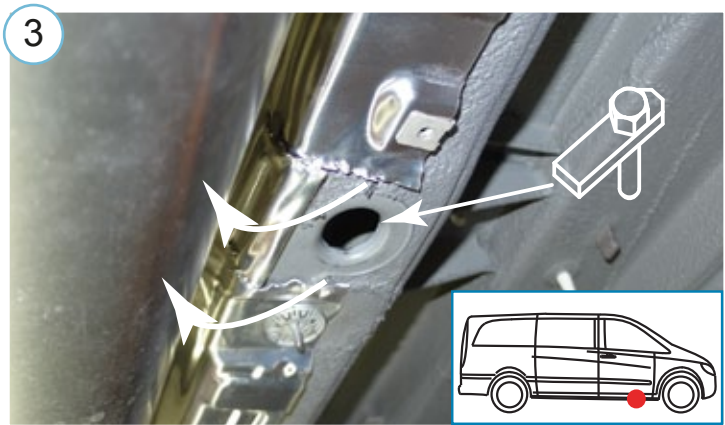
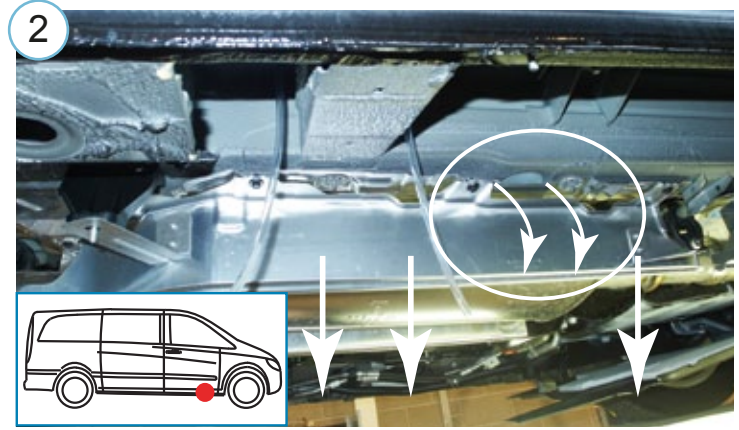

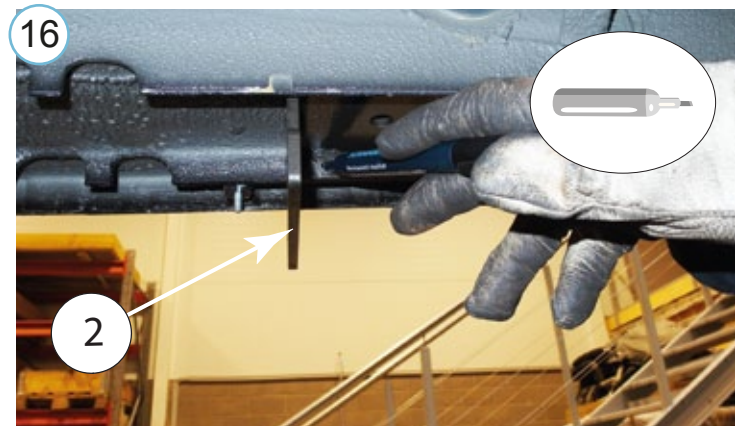
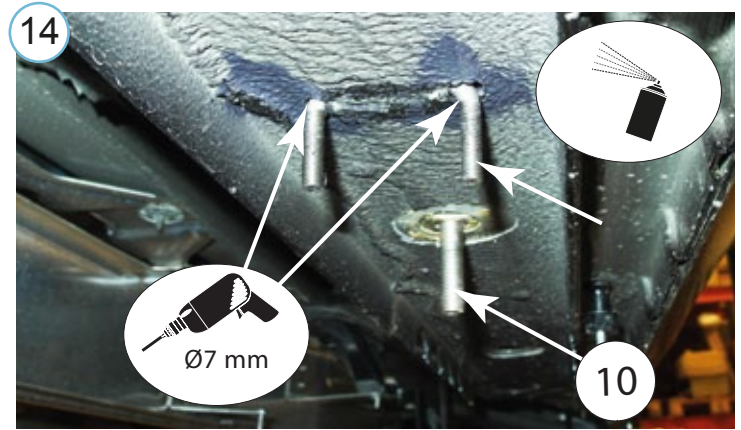
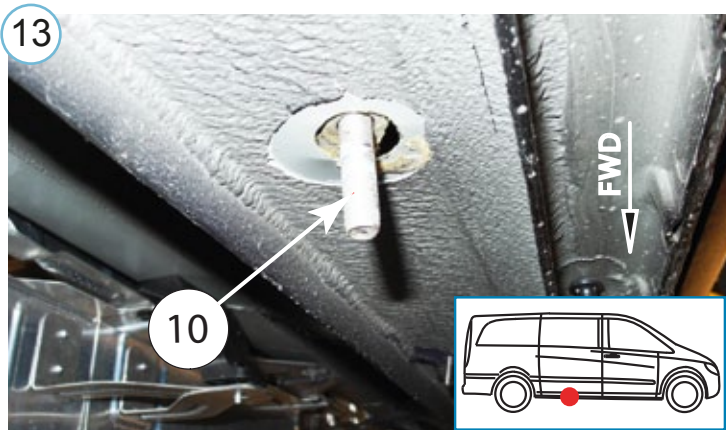
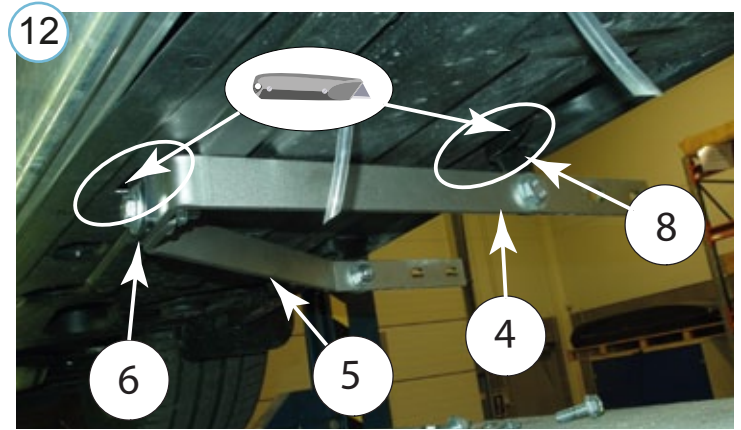
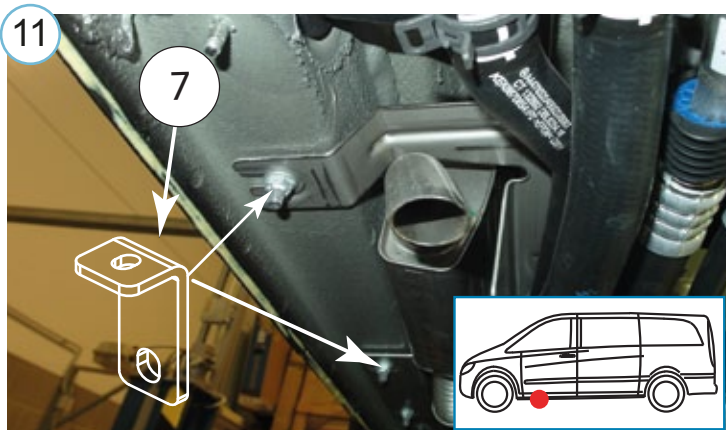
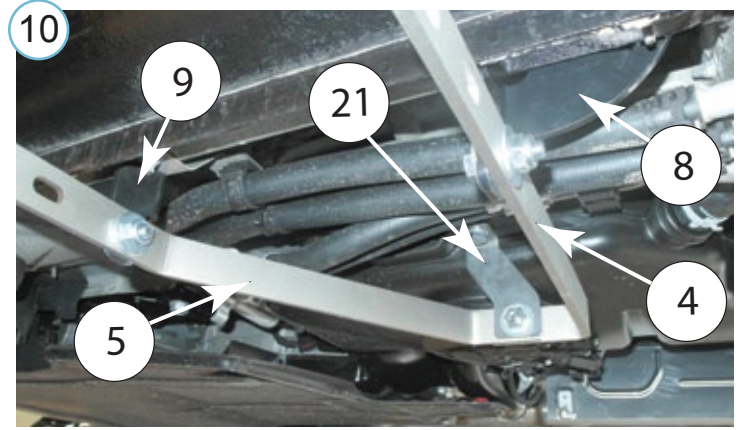
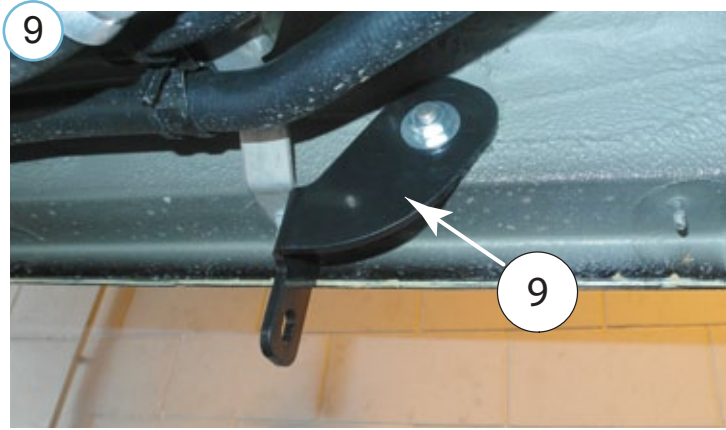

Mercedes-Benz V Klasse

EU euroraud | EU eurobar | ЕС дуга eurobar

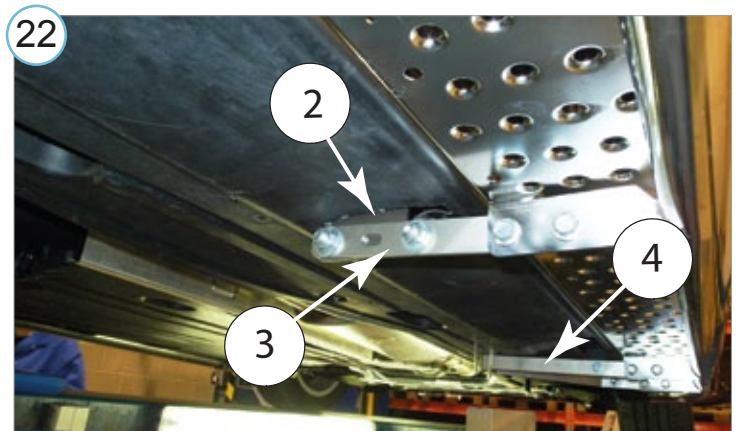
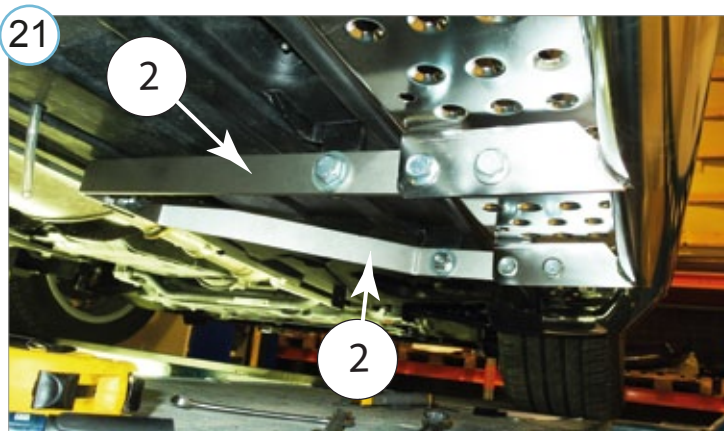
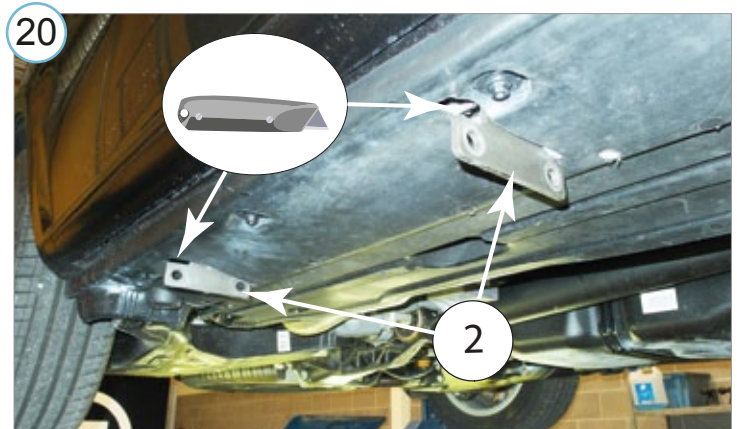
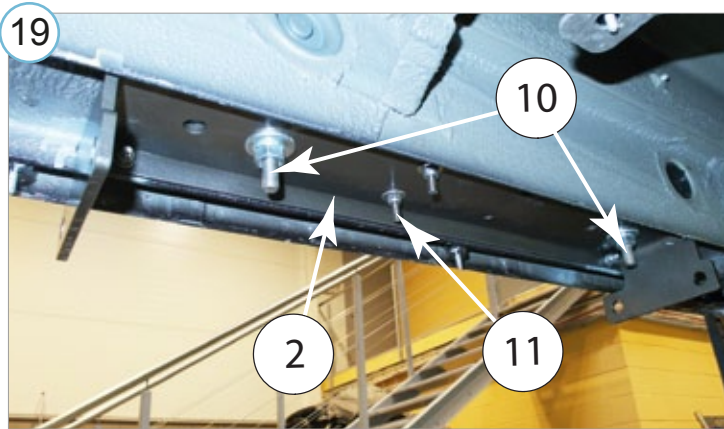
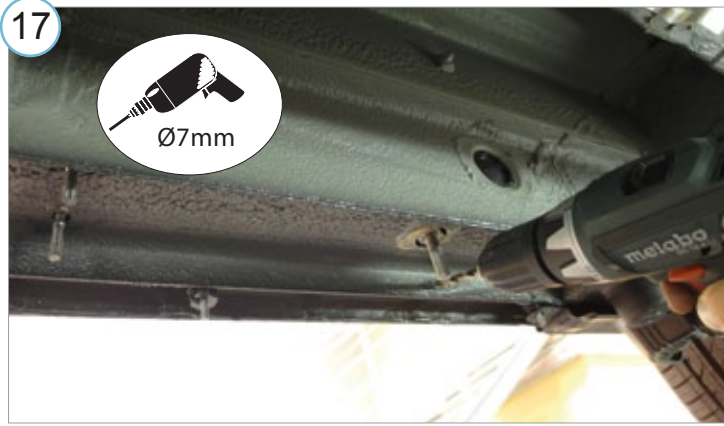

- Kui METEC toode ei vasta Teie ootustele või kui on tegemist toote ebapiisava kvaliteediga, siis pretensioonid esitada lehel www.metec.ee
- If the METEC product does not meet Your expectations or if it is a product of insufficient quality, then you can submit a claim at www.metec.ee
- Если METEC продукт не соответствует Вашим ожиданиям или это продукт недостаточного качества, то претензию предъявить можно на сайте www.metec.ee