



# Mercedes-Benzs Actros 2011-

Art. 856538, 856539-LED

Laternakandur | Lamp holder | Носител фар | Scheinwerferbügel



- |   |   |
|---|---|
| 1. Laternakandur / lamp holder / носител фар / Scheinwerferbügel    | 1 |
| 2. Vinkel / langed plate / угольник / winkel                        | 2 |
| 3. Kompensaator / compensator / компенсатор / Kompensator           | 2 |
| 4. Kompensaator / compensator / компенсатор / Kompensator           | 2 |
| 5. Polt / bolt / болт / Bolzen M8x25                                | 6 |
| 6. Polt / bolt / болт / Bolzen M10x25                               | 2 |
| 7. Seib / washer / шайба / Scheibe 8,4x24x2                         | 6 |
| 8. Seib / washer / шайба / Scheibe 10,5x20x2                        | 2 |
| 9. Vedruseib / spring washer / пружинная шайба / Federnscheibe A8   | 6 |
| 10. Vedruseib / spring washer / пружинная шайба / Federnscheibe A10 | 2 |
| 11. Tõmbemutter / rivet nut / тяговая гайка / Nietmutter M8x11x16   | 6 |
| 12. Laternaklamber / clamp for lamp / зажим для лампы / Schelle     | 6 |

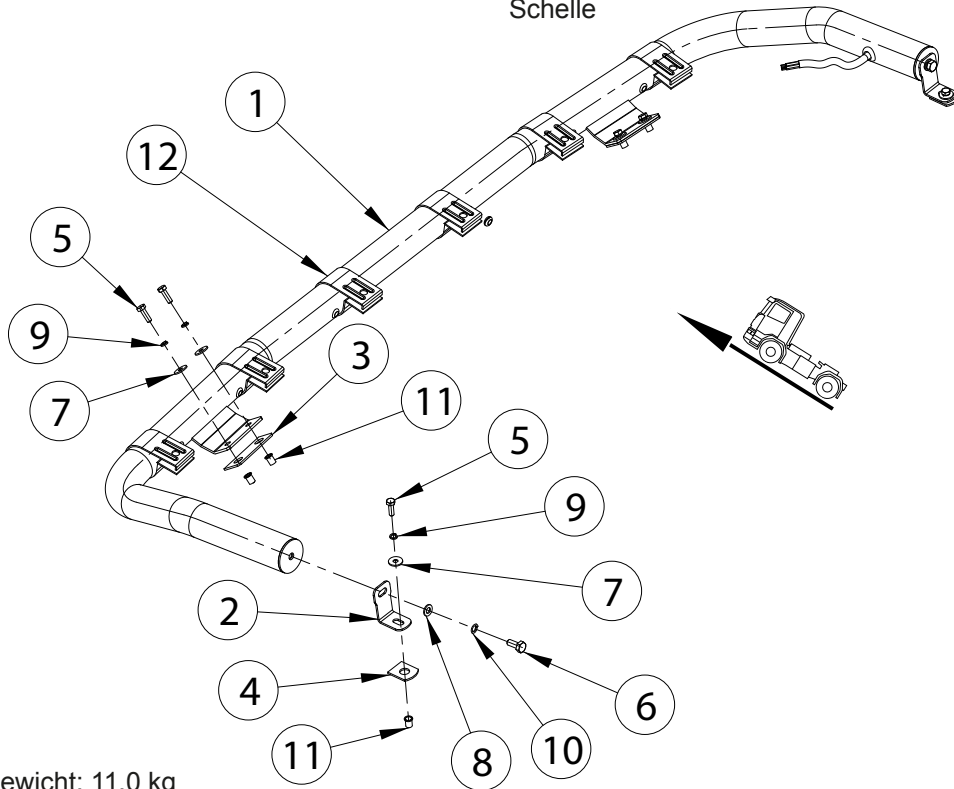

M8 - 25 Nm  
M10 - 50 Nm

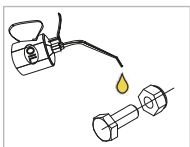

Kaal / Weight / Масса / Gewicht: 11,0 kg

Paigaldusaeg ilma elektritöödetä / Time of mounting w/o wiring works / Время установки без электромонт. работ / Einbauzeit ohne elektrische arbeit: 60 minn

Vajalikud tööriistad / Required Tools / Необходимые инструменты / Benötigte Werkzeuge

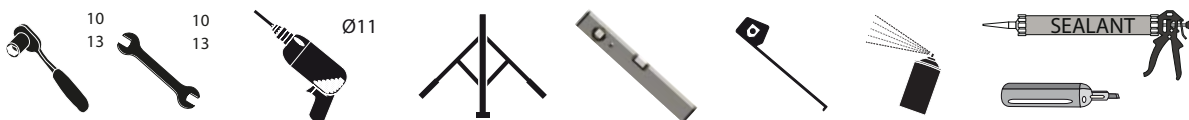

Mercedes-Benz Actros 2011-  
Laternakandur | Lamp holder | Носител фар | Scheinwerferbügel

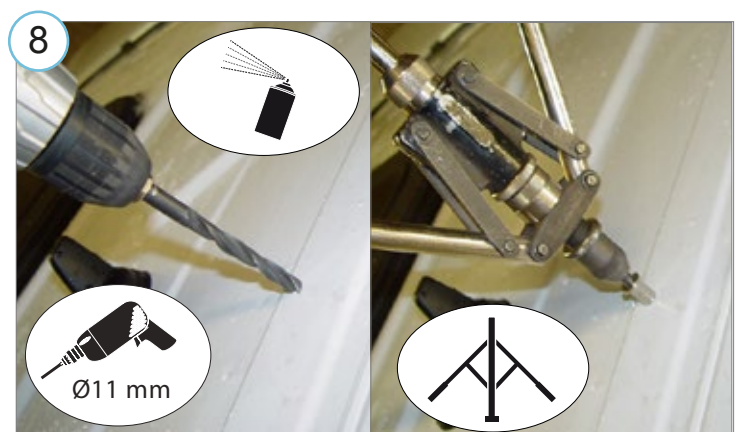
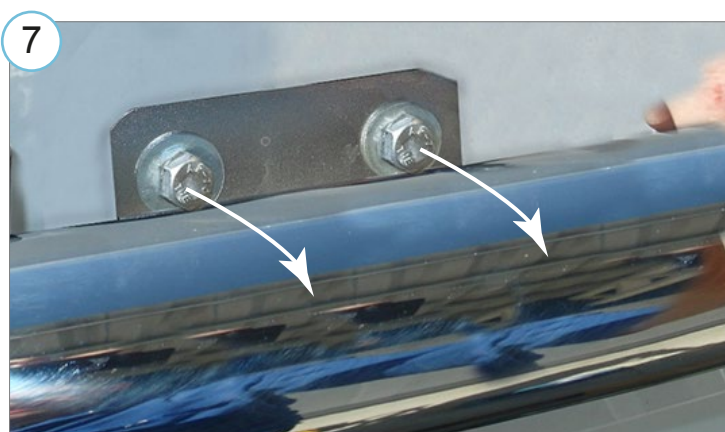
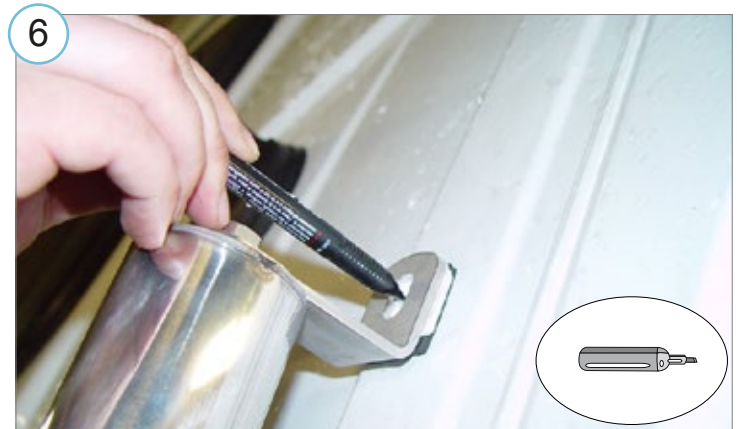
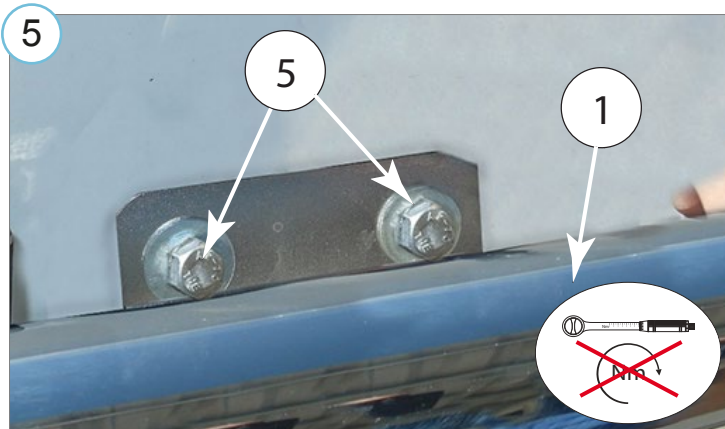
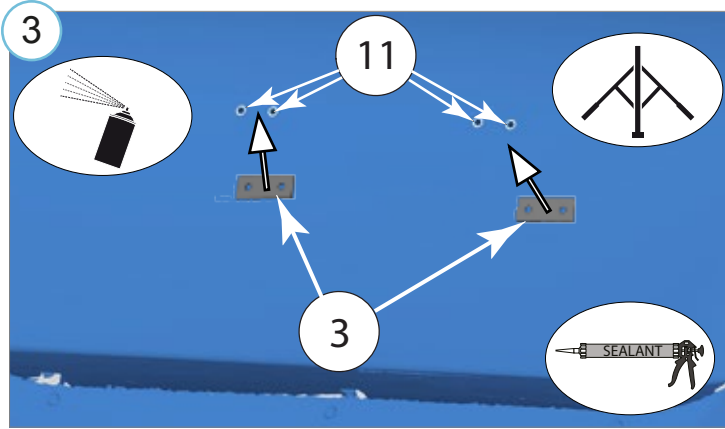
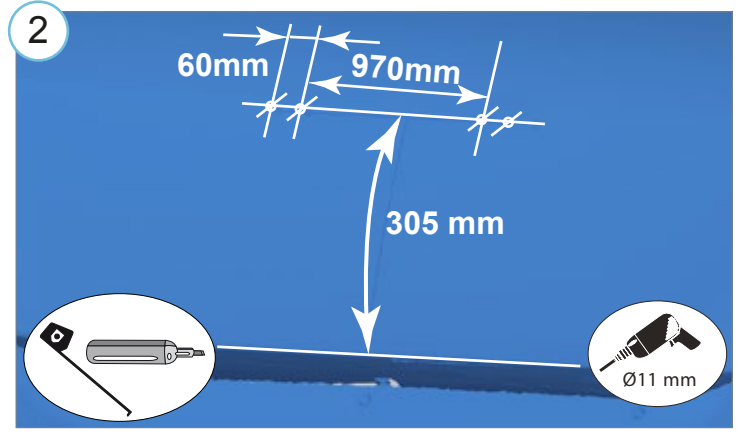
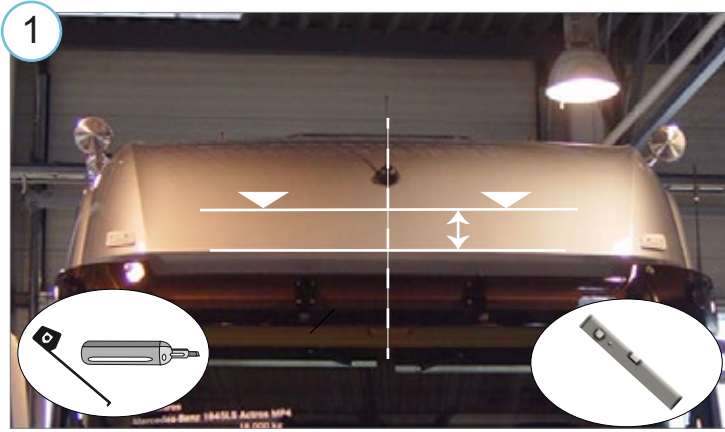

# Mercedes-Benz Actros 2011-

Laternakandur | Lamp holder | Носител фар | Scheinwerferbügel

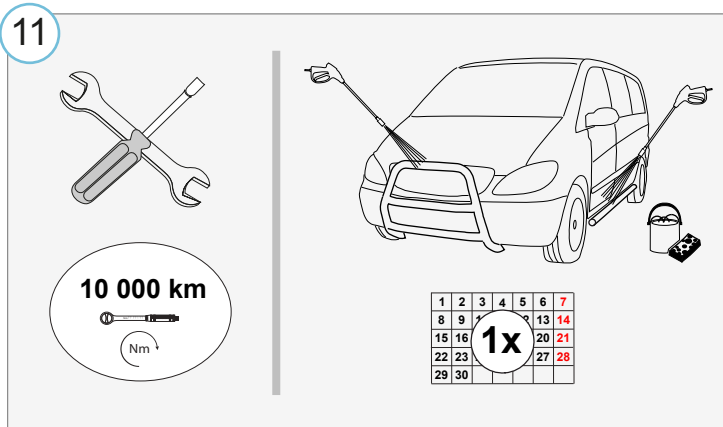
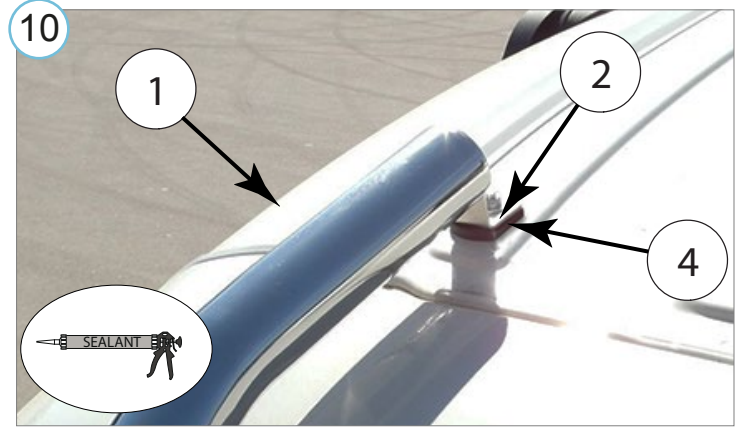
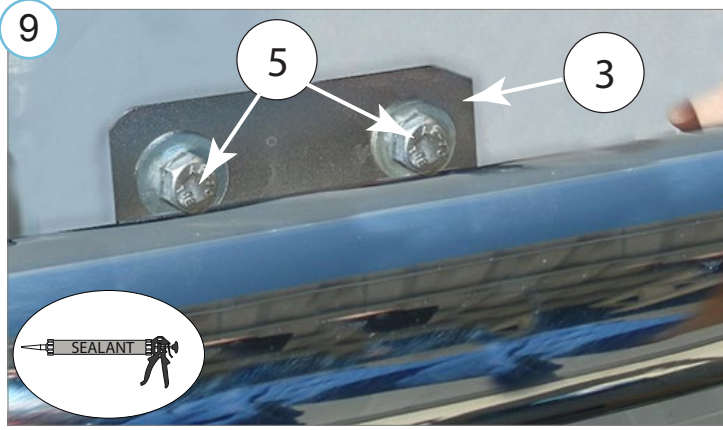

## Switching pattern of the lights of the holder.

**Juhul kui lampide A+B+C koguvõimsus ületab 280 W tuleb juhtmesarja võimalikke signaali juhtmeid (A/B) kasutada täiendavaks maanduseks! Erinevate laternate võimalik samaaegsete lülituste arv väheneb.**

**If the total wattage of the headlights A+B+C exceeds 280 W, the signal cables of the wiring harness (A/B) must be used as additional grounding! The number of possible simultaneous switching of different headlamps is decreasing.**

**Если общая мощность фар A+B+C превышает 280 Вт, сигнальные кабели жгута проводов (A/B) следует использовать в качестве дополнительного заземления! Количество возможных одновременных переключений различных фар уменьшается.**

**Falls die Gesamtleistung der Scheinwerfer A+B+C 280 W übersteigt, sind die eventuellen Signalkabel des Kabelbaums (A/B) als zusätzliche Erdung zu verwenden! Die Anzahl möglicher gleichzeitiger Schaltungen verschiedener Scheinwerfer verringert sich.**

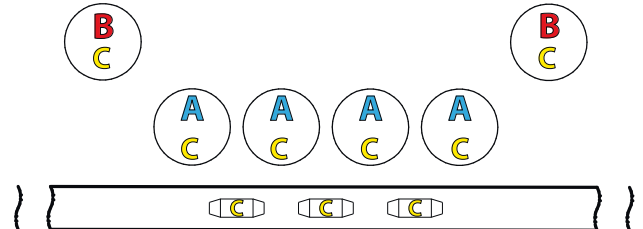

possible switch ON position	Harness ID number references / Juhtmesarjade viited			
	5G1,5	3G1,0 B	3G1,0 A	2G0,75
<b>C+</b>	1	1	1	2
<b>A-</b>	Gr/y	Gr/y		1
<b>B+</b>	2		2	
<b>A+</b>	3	2		
<b>B-</b>	4		Gr/y	