

Volvo FH 13- Globetrotter/Globetrotter XL

lamp holder TOP 6 Ø70

BATV612



BATV613



1. Lamp holder	1	5. T-bolt	2	9. clamp for lamp	6	13. washe 6,4x18x1,6	12
2. langed plate	2	6. U-bolt	2	10. bolt M8x25	6	14. washer 8,4x24x2	8
3. bracket	1	7. compensator	2	11. nut M6	4	15. spring washer A8	8
4. bracket	1	8. compensator	4	12. nut M8	2		

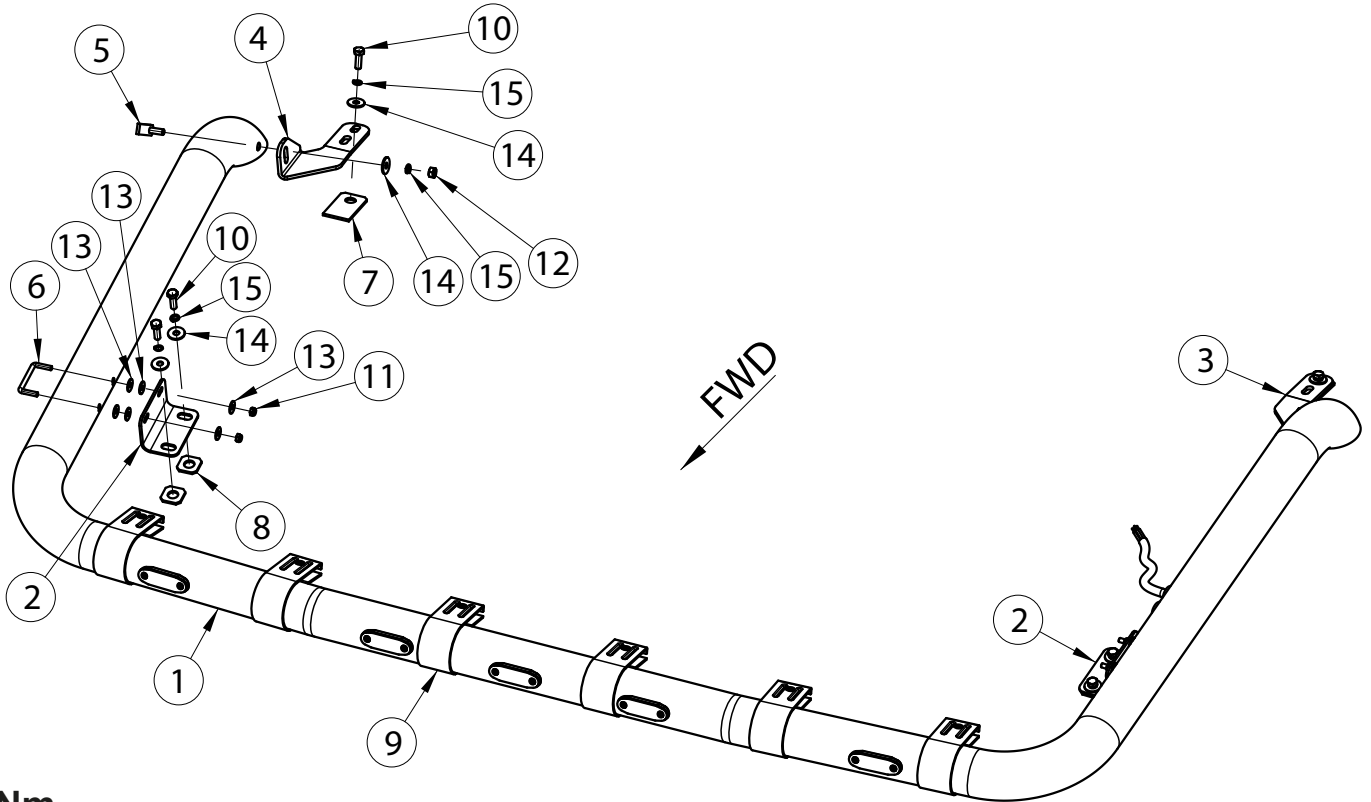

M6 - 11Nm

M8 - 25Nm

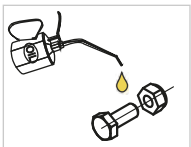

Poids : BATV612 - 12.3 Kg

BATV613 - 12.5 Kg

Temps de montage : 60 min



