

Part list:

- | | |
|----------------------|--------|
| 1. Corner spoilers | 1 pair |
| 2. Hex screw 6*25mm | 8 pcs |
| 3. Washer 6*22mm | 16 pcs |
| 4. Rubber washer 3mm | 16 pcs |
| 5. Nylok Nut M6 | 8 pcs |

1. Place the spoiler against the side spoiler and roof spoiler as on the photo and mark the hole positions.

2. Drill the holes first with a smaller drill bit (3-4mm) and then make the holes larger with 6,0mm Drill bit.

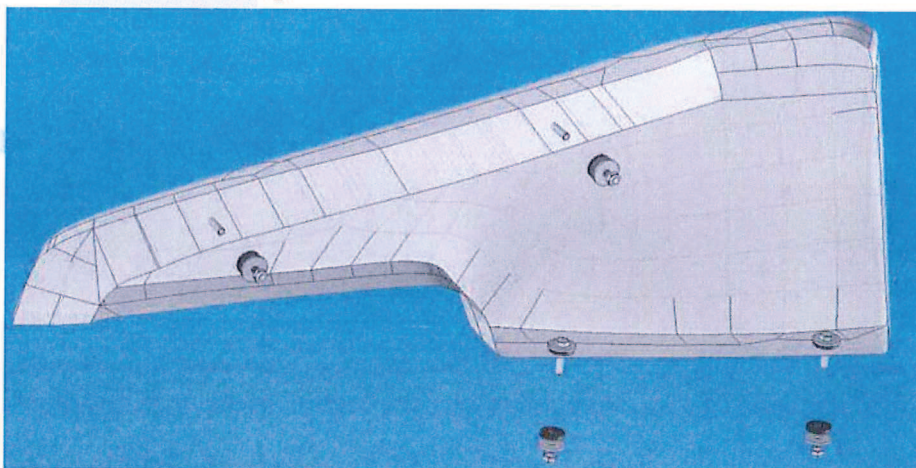

3. Mount the spoiler like on the as in the drawing. Remember to use the rubber washers to eliminate vibrations.

4. Remove the protection foil of the surface.

Read this first if you want to paint the corner spoilers!

The corner spoiler is made from ABS-PMMA plastic, which can be painted with acrylic based paints. For painting ask instructions from your paint supplier for ABS-PMMA material.

Remember to remove the protective foil before painting!