

Ø60mm

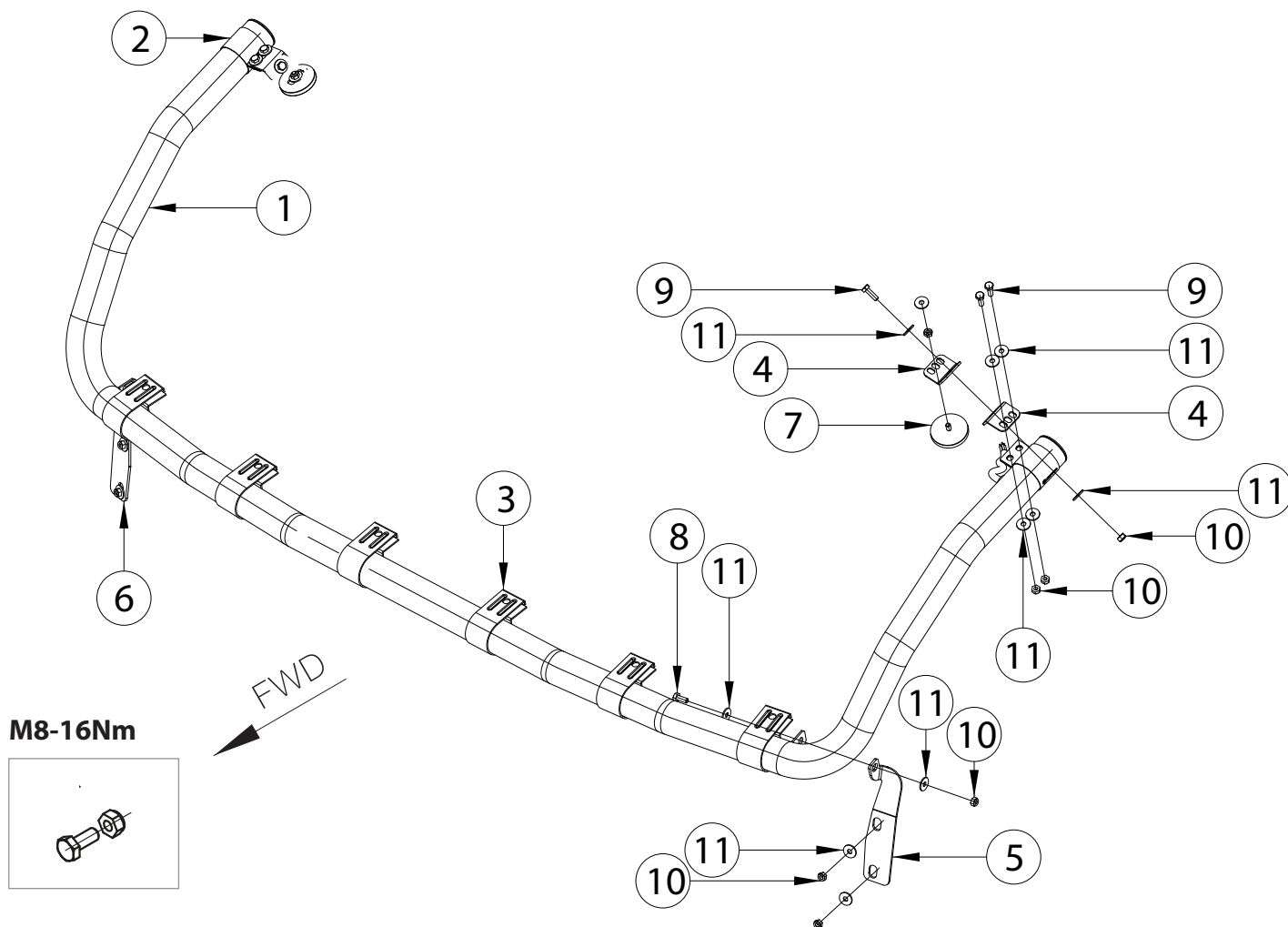

- | | |
|--|----|
| 1. Laternakandur / lampholder / носитель фар | 1 |
| 2. Klamber / clamp / зажим | 2 |
| 3. laternalamber / lamp clamp / зажим | 6 |
| 4. Kronstein / bracet / кронштейн | 4 |
| 5. Kronstein / bracet / кронштейн | 1 |
| 6. Kronstein / bracet / кронштейн | 1 |
| 7. Magnetkinnitus / magnetic fastening / магнитное крепление d=66 M8x15 mm | 2 |
| 8. Polt / bolt / болт M8x20 mm | 2 |
| 9. Polt / bolt / болт M8x25 mm | 6 |
| 10. Mutter / nut / гайка M8 DIN 985 | 14 |
| 11. Seib / washer / шайба 8,4x24x2 mm | 22 |

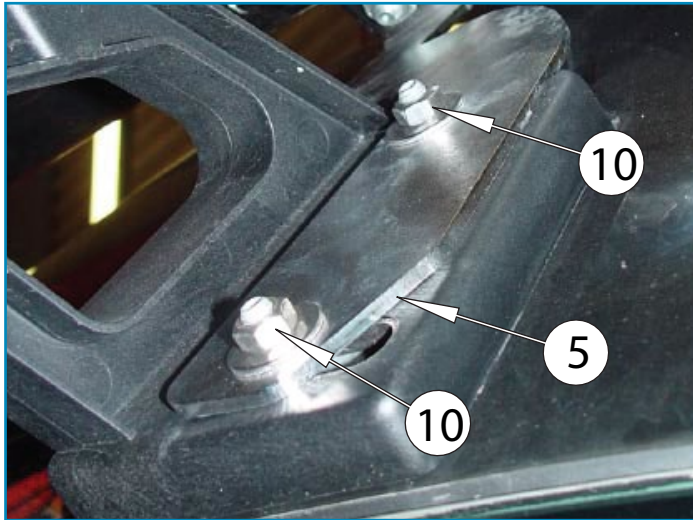



Pilt 1 / Pic. 1 / Рис. 1

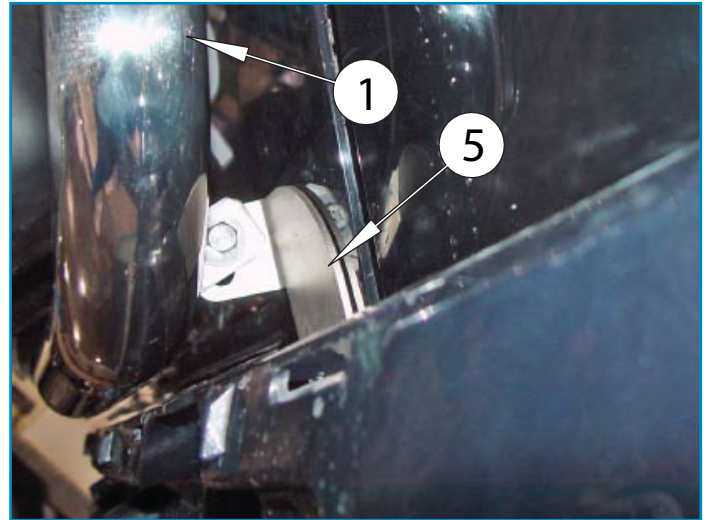

Pilt 2 / Pic. 2 / Рис. 2

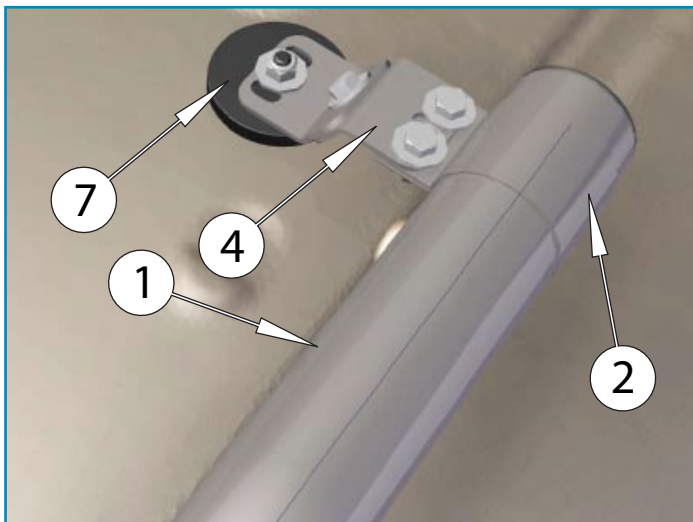

Pilt 3 / Pic. 3 / Рис. 3



Pilt 4 / Pic. 4 / Рис. 4

Dimensions : 155 x 800 x 1930 mm

Poids : BATR290 : 13.1 Kg BATR291 : 13.5Kg

Temps de montage : 30 min