

# BATV580



# BATV581

## Volvo FH 2013-

## Front protection pipe Ø 60

1. protection pipe	1	5. bolt M8x25 mm	8
2. angeled plat	1	6. nut M8 DIN 985	4
3. angeled plat	1	7. washer 8,4x24x2 mm	12
4. angeled plat	2	8. spring washer M8	4

- Measures : 65x775x2465 mm.
- Weight : 9 kg.
- Time of mounting : 20 min.

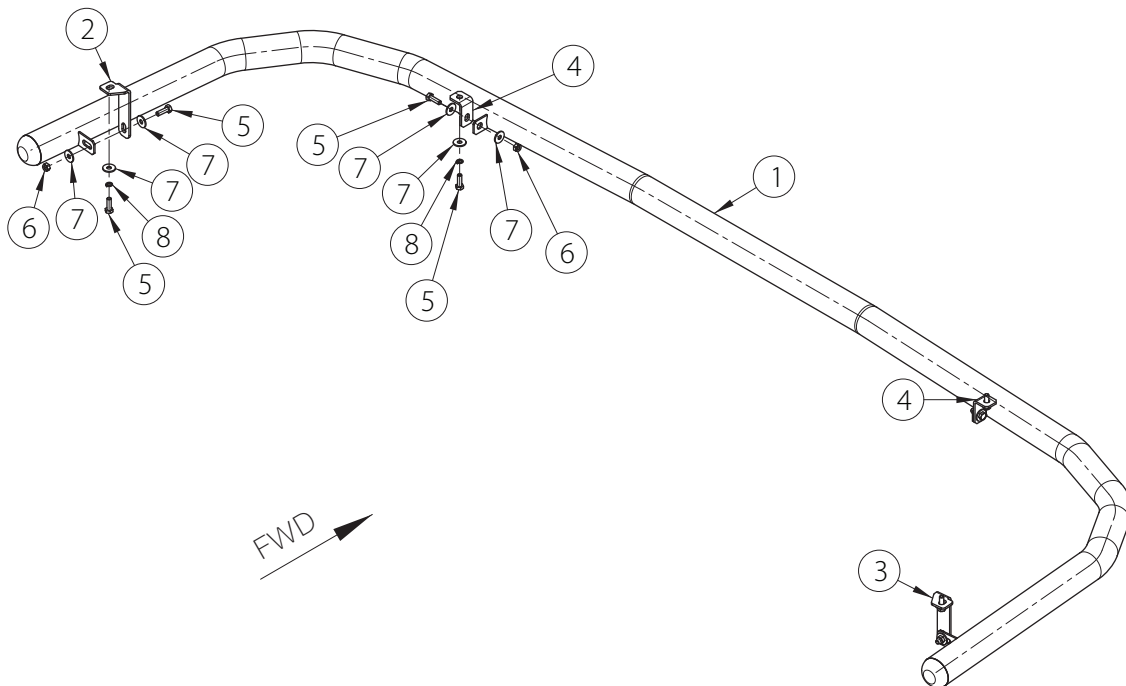

# BATV580-BATV581

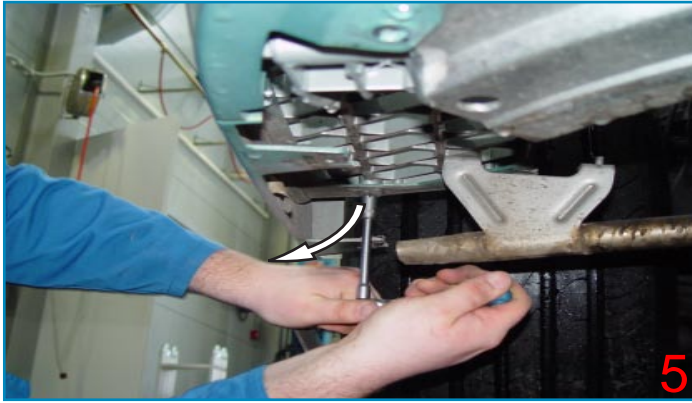

Pilt 5 / Pic. 5 / Рис. 5



Pilt 6 / Pic. 6 / Рис. 6

