



Fendt 7

Mounting instructions
Art. 887300
Lamp holder

Scan the QR code
for translated
instructions or visit
metec.ee/instructions



Weight: 17,7 kg
Time of mounting w/o wiring: 60 min

Required tools:



A2 / A4
M8 - 17 Nm
M10 - 33 Nm

Fendt 7

Art. 887300
Lamp holder

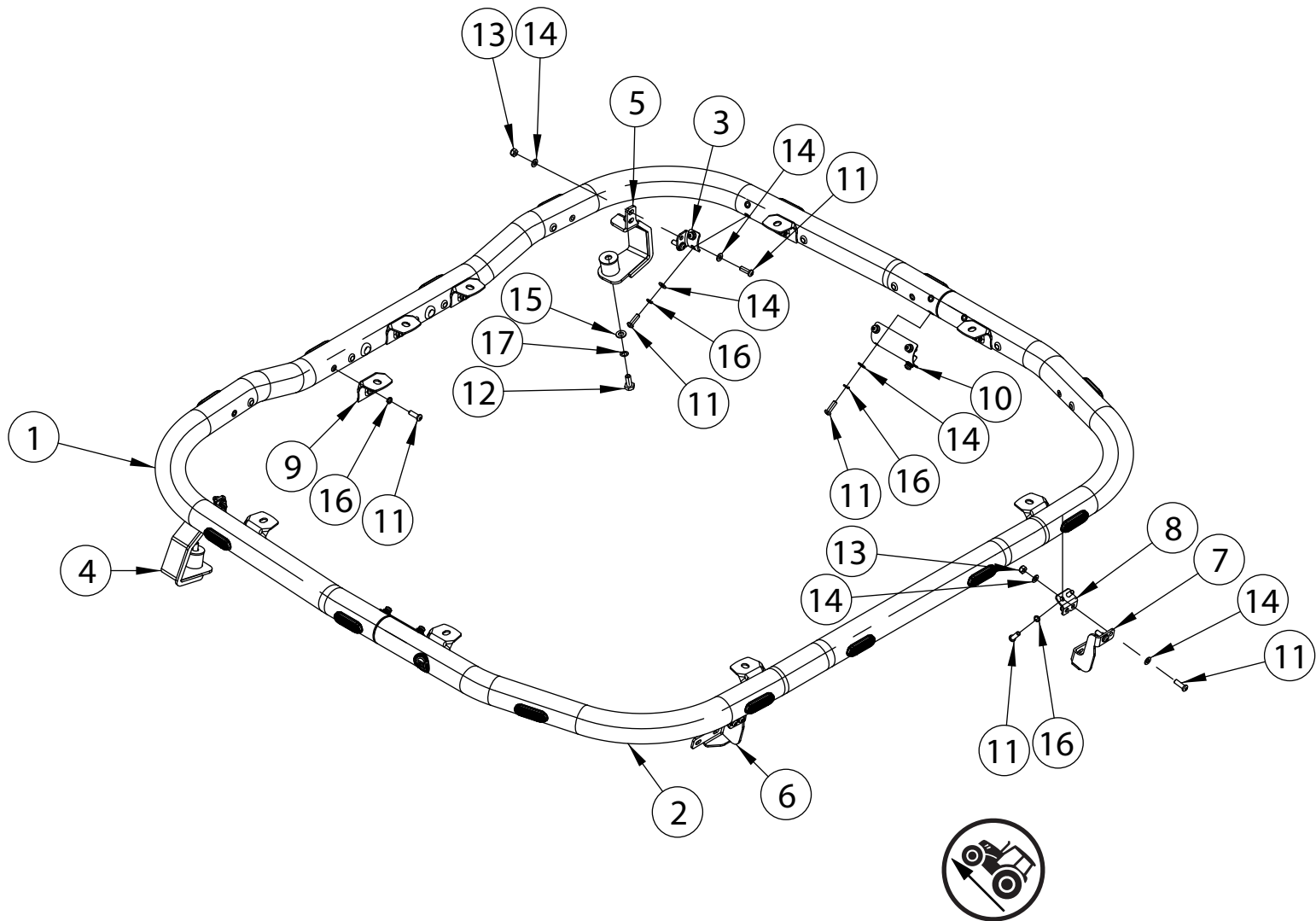

Pos	Description	QTY
1.	Arc	1
2.	Arc	1
3.	Bolt bracket	2
4.	Bracket	1
5.	Bracket	1
6.	Bracket	1
7.	Bracket	1
8.	Bolt bracket	2
9.	Lamp fixing bracket	9
10.	Pipe clamp	2

Pos	Description	QTY
11.	Bolt M8x25 DIN7380-A2	33
12.	Bolt M10x25 DIN933-A2	2
13.	Nut M8 DIN985-A2	8
14.	Flat washer 8,4x16x1,6	28
15.	Flat washer 10,5x20x2	2
16.	Spring washer A8	25
17.	Spring washer A10	2

Fendt 7

Art. 887300
Lamp holder

NB!



To prevent cold welding, use cold weld grease or engine oil



Installation of the lights must be carried out by a qualified electrician only

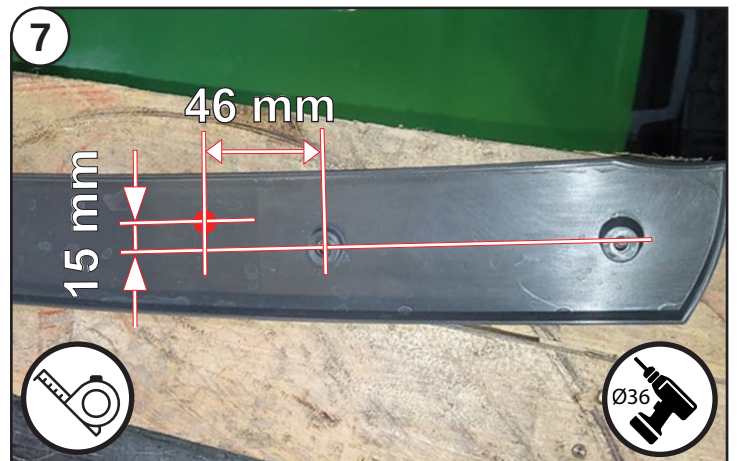
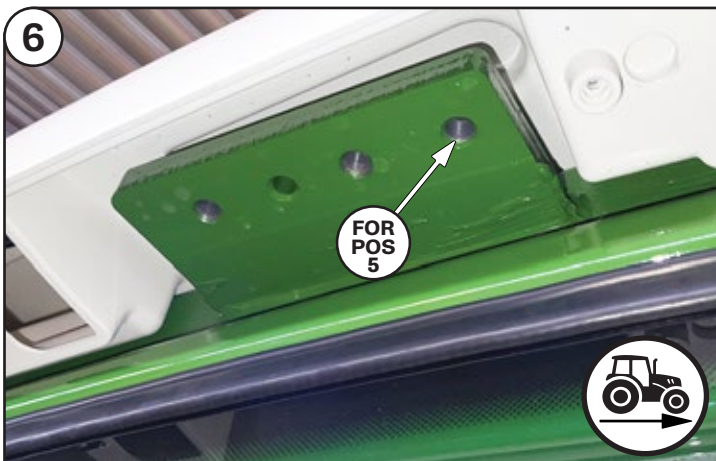
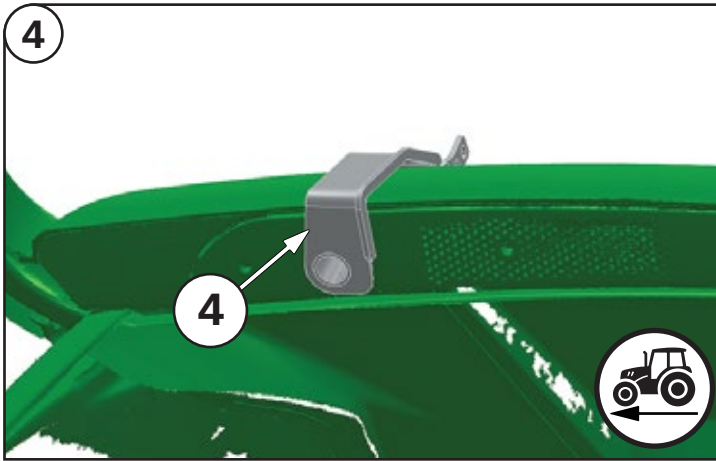
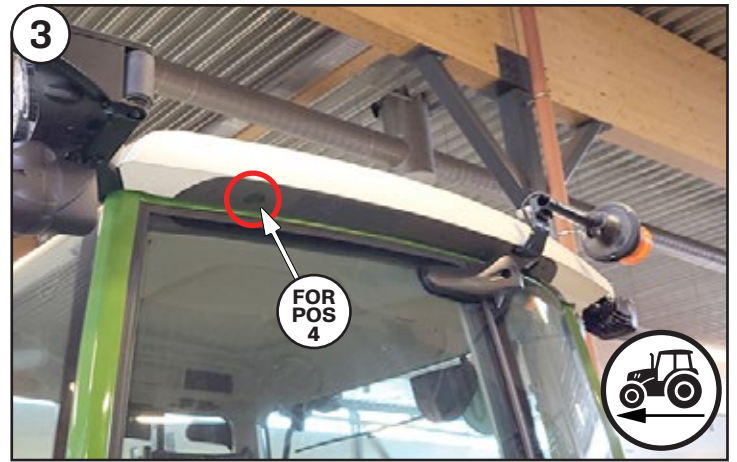
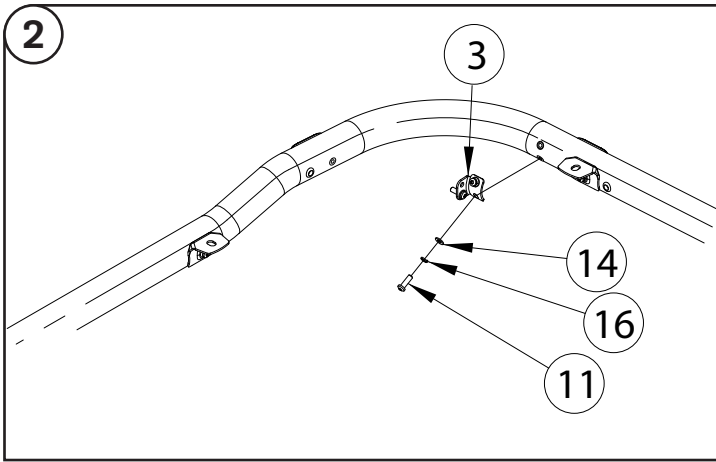
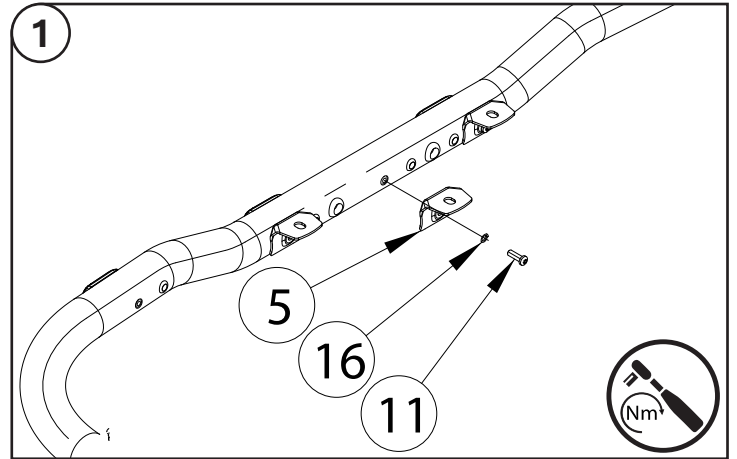

Fendt 7

Art. 887300
Lamp holder

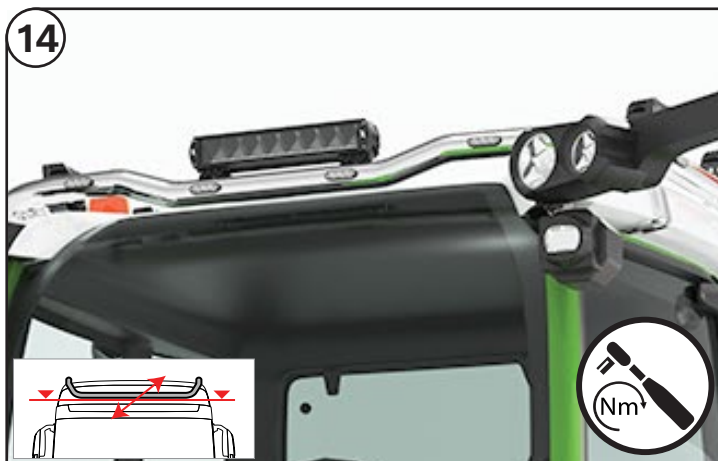
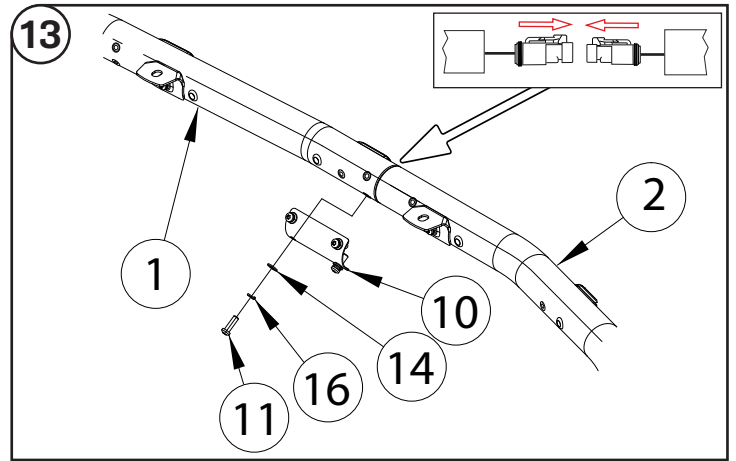
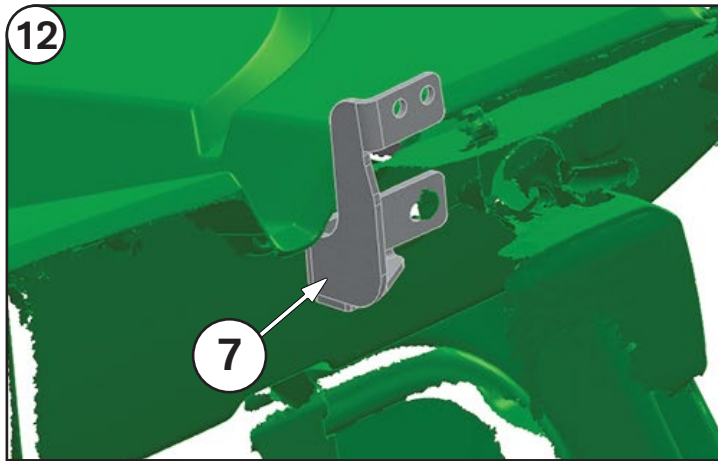
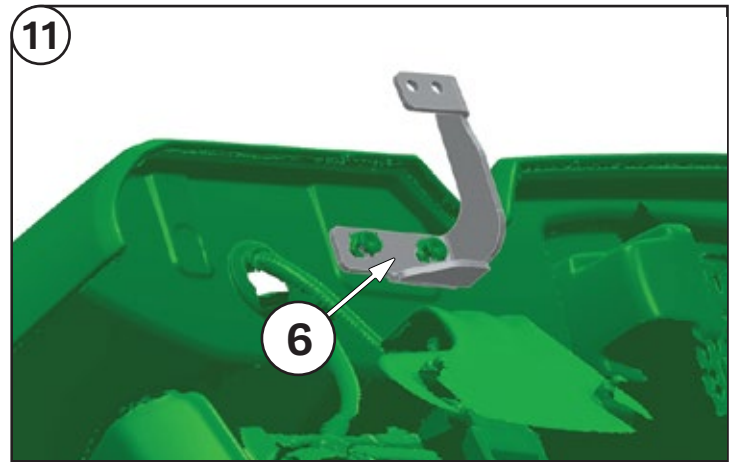
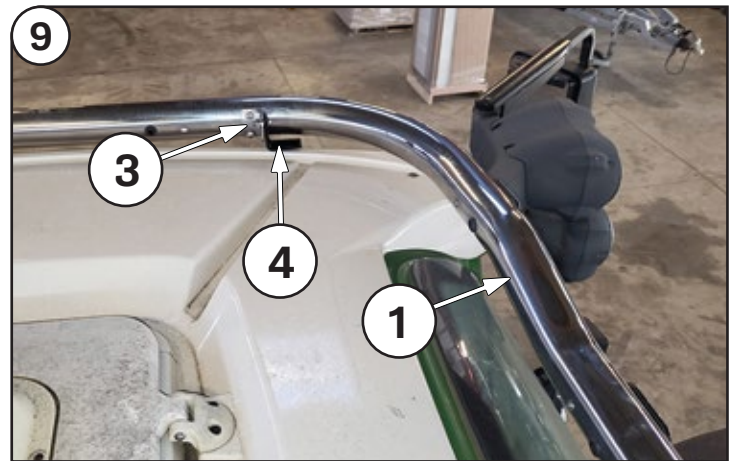
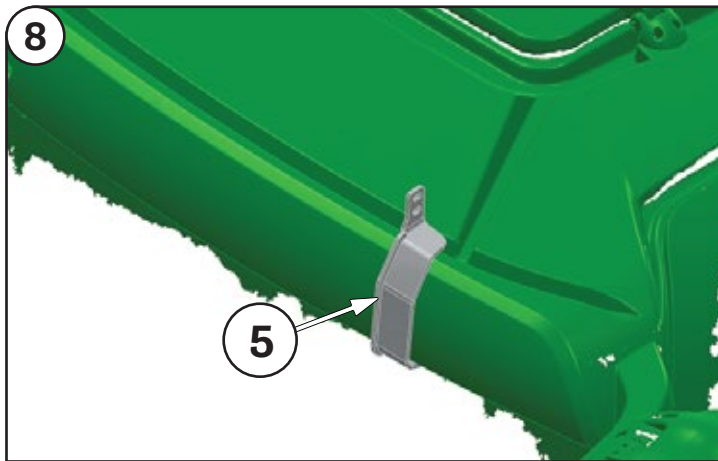

Check and retighten the fasteners after each 10 000km



Clean and wash the product twice a month to prevent corrosion

In case of any defects or damage to the METEC product upon delivery, contact the reseller or point of sale where you made your purchase for resolution